

Port Area Layout

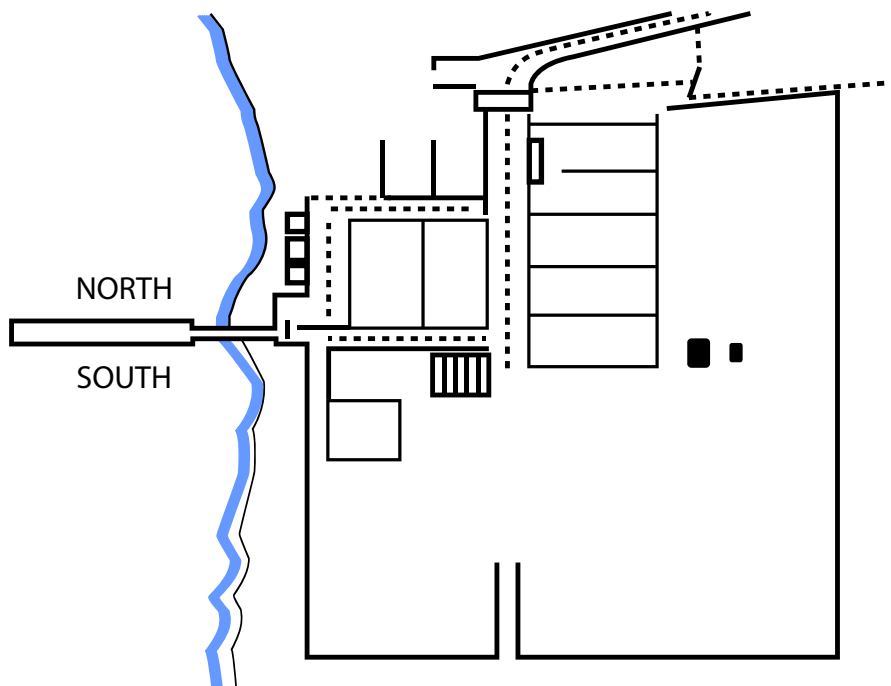

General information

OPERATION TYPE

Self Loading - Discharging or Assisted

WATER DENSITY

0.998 - 1.001

CARGO RATE

8000 - 12000 MT / 24 hrs

CARGO HANDLED

Coal, Cement, Clinker, Sugar

VESSEL RESOURCES

Ship's gears - Clamshell (Subject on contract)

SHORE RESOURCE

Ship's gears - Clamshell (Subject on contract). Crane outreach needed At least 11 - 14 mts outreach

PORT OPERATORS

Bolipuerto

DOCKS TO WEIGHT SCALE

300 - 600 mts

Services

FRESH WATER

Available at Berth

UNDERWATER INSPECTION

Available - compulsory

OTHER INSPECTIONS

Draff survey, bunker survey, hull condition, on & off hire bunker survey, ballast analyze, tally, security guard

SHIP'S PROVISION

Available - ship's chandlers must be hire

REPAIRS AND STORE

Minors

BUNKERS

Available - off shore Maracaibo

GARBAGE

Available - Compulsory

• 2 Tugboats used to open vessel off berth

• 2 tugboats used on each maneuvers in/out

Cilities	Berth N°	MAX LOA	Max Bean	Max Draft	Max Airdraft
NORTH	Dock N° 1	180	Previous port authorities approval	9	42 mtrs
SOUTH	Dock N° 1	180	Previous port authorities approval	6	42 mtrs

